

# ADDRESSABLE PUSH BUTTON

## AE/SA-PT

### Description

Manual identifiable alarm button developed and manufactured according to UNE EN 54-11: 2001, for connection to an Algorithmic Central.

This equipment is indicated for installation inside the premises, so that users can warn of a fire early. In this way, it allows to act when the effect of the fire is in its initial phase.

It incorporates a transparent protection cover to prevent accidental activations.

The design of the button allows it to be activated without breaking the pressure plate, being able to reset it again by inserting the reset key from the side.

Located in a red ABS box with measurements and screen printing according to the UNE EN 54-11 standard.



### Operation

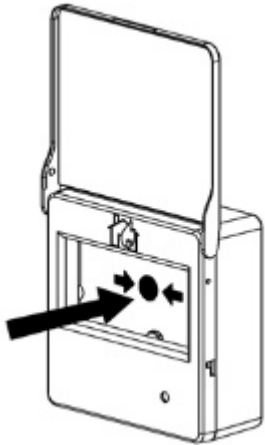

To press the button, it is necessary to lift the transparent protective cover, and press on the white sheet until it interlocks, a yellow indicator will appear at the bottom. The manual button will go into alarm status by activating the red LED continuously.

It includes:

- \* Function indicator: Indicates its correct operation by flashing red by the alarm LED.
- \* Transparent protection cover.
- \* Sheet calibrated so that it interlocks and does not break screen printed according to UNE EN 54-11: 2001.
- \* Input and output connection terminals.
- \* Levels of alarm, rest and communication failure with the algorithmic loop.
- \* Individual identification: Each button is individually identified with a number within the installation loop. This number is stored in EEPROM memory so it is maintained even if the button is without power for a long time.

### Installation Precautions

- For installation follow the recommendations given in the installation standard EN 54-11.
- Ensure that the button is as clearly visible, identifiable and accessible.
- If the button is recessed, the right side must be free to enter the reset key.
- Make sure it is firmly attached to the wall.

### Wiring



Disconnect the supply voltage from the detection loop before installing the button.

- Connect the positive input of the detection loop to an L terminal.
- Connect the negative input of the detection loop to a C terminal.
- Connect the positive output of the detection loop to the free L terminal.
- Connect the negative output of the detection loop to the free C terminal.

Once the cables are connected, reassemble the front of the button by inserting it into the box, first the upper part tilting and matching the tabs, and then pressing lightly on the bottom.

### TECHNICAL CHARACTERISTICS:

Supply voltage:	18 ~ 27 V (Algorithmic loop card AE/SA-CTL).
Standby Current:	0.9 mA
Consumption in alarm:	3.8 mA
Wiring:	2 wire. Sección recomendada AWG 22~14 (IEC1.5mm2)
Temperature range:	-10° - +50° C (temperatura ambiente)
Humidity range:	Relative humidity 10% - 90% non-condensing.
Housing material:	ABS
Protection degree:	IP42 (indoor installation).
TYPE:	A

Signal lamp:	Operational tell-tale:destello rojo
Alarm:	Flashing red
Dimensions:	98 x 95 x 39 mm.

#### CERTIFICATE

0099/CPD/A74/0073

